



House with entrance to the apartment

Costs (as of January 2020)

For up to 2 persons: € 370 per week and € 65 per day for a period of less than a week. Further person: € 50 per stay - min. is 3 days. Children under 3 are free.

Dogs are welcome by prior arrangement only: € 30 per stay .

Bed linen, towels, final cleaning, telephone, internet and electricity are included.



Partial view of the living room



View of Bacharach from the other side of the Rhine

How to find us:

Coming from the South:

Motorway exit Bingen/St. Goar and follow the B9 north towards St. Goar. After 20 minutes you will see a rubble masonry house to your left. Turn off left. and left again up the hill (signposted Medenscheid). Follow the signs for Medenscheid.

Coming from the North:

Motorway exit Rheinböllen. In Rheinböllen follow signs for Bacharach. Pass through Steeg and down into Bacharach. At the market square and Church of St. Peter, turn right. After the city limits sign, turn right up the hill (signposted Medenscheid). Follow the signs for Medenscheid.

In Medenscheid, drive through the village, straight, to the end. The apartment is in the last house on the left.

Holiday apartment with a view



View from the terrace

Holidays for 2 to 4 persons near Bacharach on the hills of the world cultural heritage Middle Rhine Valley, with a direct view of the Rhine. Ground level apartment 55m², living room, bedroom, kitchen and bathroom, separate entrance and car parking bay.



View from the living room

Gerhild and Peter Weiss
Weingartenstr. 1

55422 Bacharach-Medenscheid

phone 0049-(0)6743-937224

mail@weiss-am-rhein.de

http://www.ferien.am-mittelrhein.de

The apartment

The Rhineview House was built in 1996 and is situated 150m over the Rhine valley. It is a ground level apartment (no stairs) and offers stunning views of the Rhine. It is fully equipped (kitchenware, refrigerator, microwave and satellite TV). There is a living room, bedroom, kitchen and bathroom (with tub and shower) offering ample room for up to four persons. There is a separate off-street parking bay. The terrace with garden furniture is perfect for sunbathing and relaxing. The apartment has its own **telephone** line and **Internet** connection. WiFi is free of charge.

However, the most important feature is the marvellous view of the river Rhine and the hills beyond.

The house is in a very quiet location at the end of the village. There is no substantial noise disturbance from the railway or road as is the case in many places located down in the valley.

Conditions

Bed linen and towels are provided. We let the apartment on a per-week basis; the per-day rent is higher for shorter periods. We prefer to let from Saturday to Saturday.

Smokers are welcome, but in the house no one should smoke.

Activities

The "Rhine Castle Path" goes right past the house. This 68km hiking trail runs from Bingen to Koblenz. There are also many smaller trails through the vineyards and around the village with wonderful views of the Rhine valley.

The Rhine valley also attracts cyclists with well-maintained cycle paths.

From Bacharach, tour boats head downstream towards Koblenz passing the famous Loreley rock, offering views of the many castles. Heading upstream they go to Rudesheim and the Niederwald monument.

On a rainy day, both Mainz and Koblenz are easy to reach by car or train.

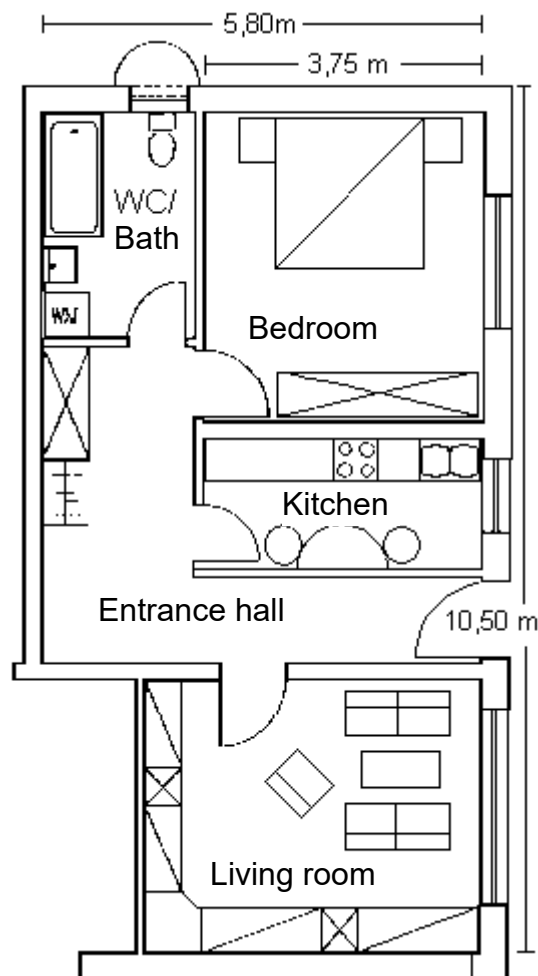

Layout of the apartment

The village Medenscheid

Medenscheid is a village with approximately 180 inhabitants and belongs to Bacharach. It is situated on a hill-top and looks down to the Rhine valley from a height of 150m.

The city of Bacharach

Bacharach is situated between Bingen and Koblenz and has about 2300 inhabitants in total. During the summer, the city is a favourite spot for tourists, who are primarily attracted by the "Rhine Romance". Bacharach is a medieval town with small lanes, half-timbered houses, a real castle and numerous wine restaurants.

Stahleck castle accommodates a modern youth hostel. In the vineyards, half-way down the hill from Stahleck castle, you will find a cultural monument and a treasure of gothic masonry: the ruin of the former Werner chapel. The Church of St. Peter in the market square dates back to 1350.

The Middle Rhine Valley

The Middle Rhine Valley, from Koblenz to Bingen, was declared a UNESCO world cultural heritage site in 2002. This stretch of about 65 kilometres is a cultured landscape offering great variety and beauty.

There are also several firework displays, including the "Rhine in Flames". They are organized on several weekends from the start of May to the end of September at many locations.

The last Sunday in June is "Tal-to-Tal" on both sides of the river Rhine - the roads are open to pedestrians and cyclists only. Every weekend during the summer there are numerous wine festivals, village celebrations, farm and vineyard events.